



Installation Precautions:

- 1 Before installing the faucet, be sure to remove the Impurities and sludge and other sundries, so as not to block and affect the water outlet function
- 2 The working water pressure of the faucet is 0.1-05MPa
- 3 If the pictures or text descriptions in this installation manual are different from the actual If it does not match, please refer to the actual product!

安装注意事项:

- 1 安装龙头前，请务必先清除预埋的供水管内的杂质及污泥等杂物，以免堵塞，影响出水功能
- 2 龙头的工作水压为0.1-05MPa
- 3 此安装说明书中的图片或文字描述，若与实物不符，请以实物为准!

产品型号:

GB-B221058CP\RG
浴缸龙头，镀铬、玫瑰金

辅助工具:

Auxiliary tools:

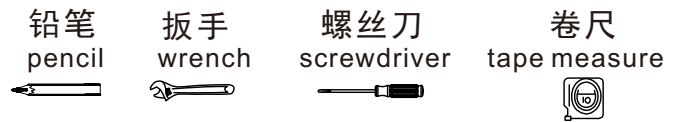

配件示意图:

Schematic diagram of accessories

安装尺寸图 单位:mm

Installation dimension drawing Unit: mm

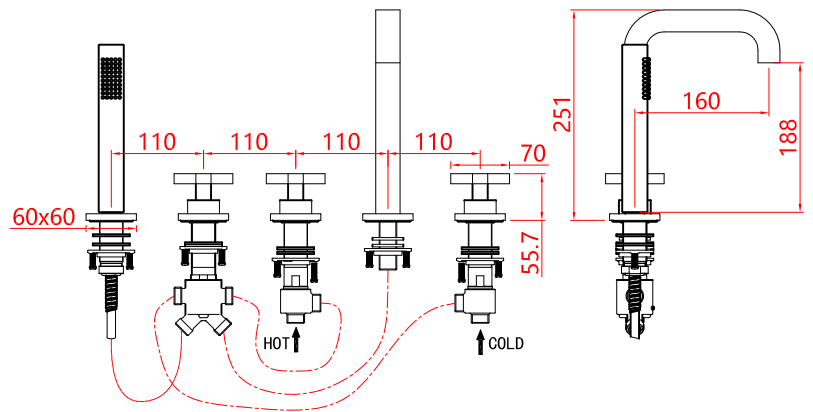
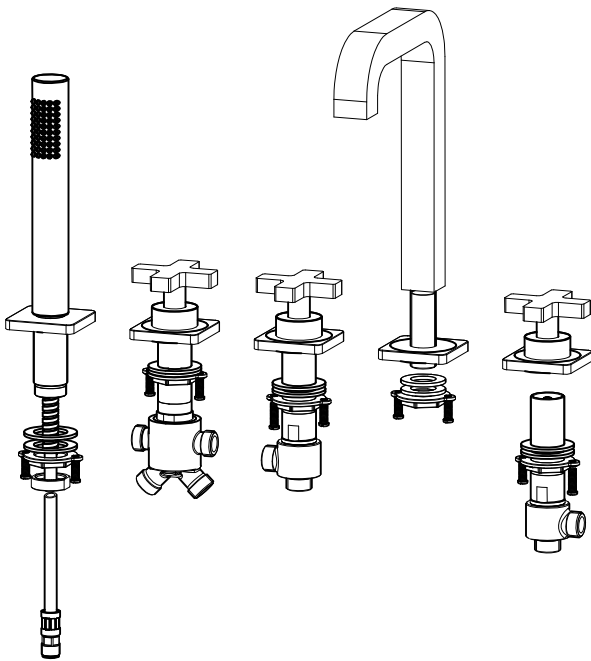

开孔尺寸图 单位:mm

Hole size drawing Unit: mm

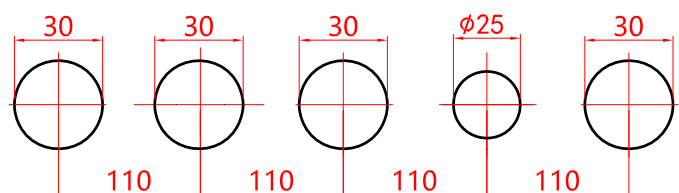

安装步骤说明:

Installation Step Instructions :

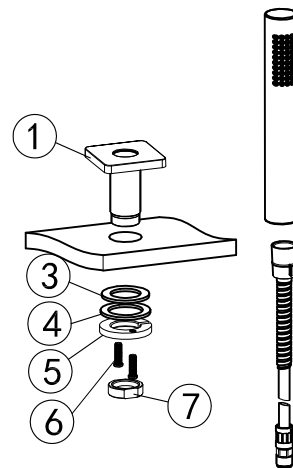
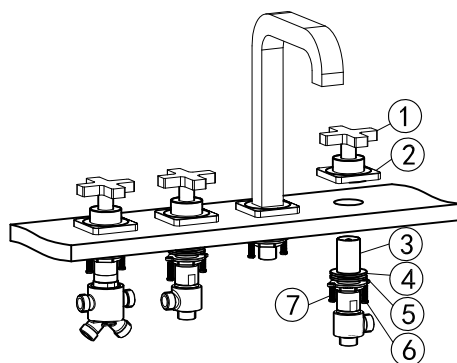
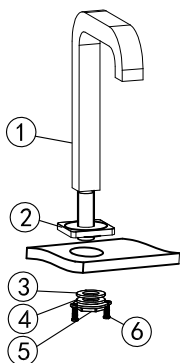

将出水嘴(1)从台面上通过底座(2)插进预先开好的孔内。按顺序把垫片(3)不锈钢垫片(4)和螺母(5)套进牙管并拧紧。将螺钉(6)拧到螺母(5)上并用螺丝刀锁紧。

Insert the water outlet (1) from the table through the base (2) into the pre-opened hole. Put the gasket (3), the stainless steel gasket (4) and the nut (5) into the tooth tube in sequence and screw tight. Screw the screw (6) onto the nut (5) and tighten with a screwdriver.

a将垫片(4)不锈钢垫片(5)螺母(6)分别套进三通上。b将进水三通(3)从台面下通过预先开好的孔套进把手组(1),通过把手组下的底座(2)跟进水三通旋好,并调好把手杆方向。c锁紧螺母(6),将螺钉(7)拧到螺母(6)上并用螺丝刀锁紧。(分水阀安装同样方法)

a Put the washer (4) stainless steel washer (5) and the nut (6) into the tee respectively. b. Insert the water inlet tee (3) into the handle group (1) through the pre-opened hole from under the table, follow the water tee through the base (2) under the handle group and screw it well, and adjust the direction of the handle rod. c Tighten the nut (6), screw the screw (7) onto the nut (6) and tighten it with a screwdriver. (The same way to install the diverter valve)

a将花洒座(1)从台面上插进预先开好的孔内。按顺序把垫片(3)不锈钢垫片(4)和螺母(5)套进牙管并拧紧。将螺钉(6)拧到螺母(5)上并用螺丝刀锁紧,把配件(7)拧紧在花洒座(1)上。b最后把花洒和花洒软管分别装好。

a Insert the shower seat (1) from the table top into the pre-drilled hole. Insert the gasket (3), the stainless steel gasket (4) and the nut (5) into the tooth tube in sequence and tighten. Screw the screw (6) onto the nut (5) and tighten it with a screwdriver, and tighten the fitting (7) on the shower seat (1). b Finally, install the shower head and the shower hose separately.

Cleaning Instructions:

清洗说明:

Use clean water and a soft cotton cloth to remove as much dirt and scale film on the surface as possible. or with Clean the coating surface with neutral soapy water and dry it thoroughly with a clean soft cloth The entire surface, many cleaning agents such as ammonia, detergent powder and toilet cleaner etc., it will cause damage to the electroplating surface and should not be used.

使用清水及软棉布,尽量清除表面污垢及垢膜。或以中性肥皂水清洗镀层表面,再以干净的软布彻底擦干整个表面,许多清洁剂,比如氨水、去污粉及洁厕灵等,会对电镀表面造成伤害,切忌使用。

Abrasive cleaning utensils or detergents are not Can be used on our company's faucets and accessories.

有磨损性的清洁用具或清洁剂也不可适用于本公司的水龙头及其配件上。

Special statement:

特别申明:

This product manual is based on the latest product information. company in suranceto make changes at any time without notice to product characteristics, packaging or The right to type of product available is subject to change without notice.

本产品说明书是根据最新产品资料编写。公司保留任何时候不经通知即可改变产品特性、包装或产品类型权利,如有变更,恕不另行通知。

Warranty Brochure

Maintenance terms

respected user:

Thank you for using the company's products. In order to make it more convenient and correct for you to use this product, please read the "Warranty Manual" carefully and keep all the information properly. We wholeheartedly provide you with the following services:

- 一. Warranty period This product is proved to be installed and used normally, since the date of purchase Year free maintenance. After the warranty period, spare parts and labor costs will be charged.
- 二. Free maintenance regulations
 1. During the warranty period, according to the instruction manual, precautions and other contents within the normal range of use. If it fails, the company will repair it free of charge.
 2. In the event of a failure during the warranty period for free maintenance, show the warranty to the store or relevant unit. Repair card or purchase invoice.
- 三. Even within the warranty period, paid maintenance is required in the following cases
 1. Due to improper use, misoperation caused by bad conditions and improper disassembly and repair by yourself, or by yourself. Malfunctions and damages caused by modification.
 2. After the installation is completed, there are failures and damages caused by re-moving.
 3. Due to force majeure factors (fire, earthquake, flood, lightning strike, freezing and other natural disasters), failure and damage caused by pollution and gas disasters, hydrochloric acid)
 4. Poor use due to sand deposition and dirt in the water quality.
 5. Damage caused by other construction errors.
 6. There is no warranty card or a valid purchase invoice.
 7. The information recorded on this warranty card is inconsistent with the actual product marking or has been altered.
 8. Failure and damage caused by use in places other than ordinary households (such as public places).

保修手册

维修条款

尊敬的用户:

感谢您使用本公司产品, 为使您更方便正确的使用本产品, 请仔细阅读《保修手册》并请妥善保管所有资料, 我们竭诚为您提供下列服务:

- 一、保修期限本产品被证明正常安装和使用的前提下, 自购买之日起公司五年免费维修。超过保修期, 需收取配件及人工费用。
- 二、免费维修规定
 - ① 保修期内, 按照使用说明书, 注意事项等内容正常使用范围内出现故障的, 本公司将免费维修。
 - ② 在保修期内发生故障进行免费维修时, 向专卖店或相关单位出示保修卡或购买发票。
- 三、即使在保修期内, 以下情况要有偿维修
 - ① 因使用不当, 误操作引起的不良情况及自行拆卸不当修理, 或自行改造造成的故障及损伤。
 - ② 在安装完毕后, 有再行移动而引起的故障及损伤。
 - ③ 因不可抗力因素(火灾、地震、水灾、雷击、冰冻及其他的自然灾害, 公害及气体灾害、盐酸)引起的故障及损伤
 - ④ 因水质的沙土淤积, 污物而产生的使用不良。
 - ⑤ 其他施工的失误造成的损伤。
 - ⑥ 无本保修卡或无有效购买发票的情况。
 - ⑦ 本保修卡上记录的信息与商品实物标示不符或涂改的。
 - ⑧ 普通家庭以外场所使用(例如公共场所)造成的故障及损坏。

sales record

Customer Information	client's name
	address
	telephone
Dealer Information	name
	telephone
model	
Product Series	
purchase date	day moon year
warranty period	Free maintenance for five years from the date of purchase

销售记录

客户信息	客户名称
	地 址
	电 话
经销商信息	名 称
	电 话
型 号	
产品系列号	
购买日期	年 月 日
保修期	自购买日起五年免费维修

Warranty record

Warranty date	Trouble and Handling	Warranty staff

保修记录

保修日期	故障及处理情况	保修人员

Thank you for choosing our company's products. If there is a problem in use, please check it yourself according to the product manual. When you cannot rule it out, please contact the dealer or the local repair center designated by our company in time.

感谢您选用我公司的产品, 在使用中出现问题时, 请按产品说明书简单的排除自行检查。当您无法排除时, 请及时与经销商或本公司在当地指定的维修中心取得联系。